

ASSEMBLY INSTRUCTION

MODEL : CF 8815 (5'6")

Step 1 : Install the legs (D) to footboard (B) and headboard (A).

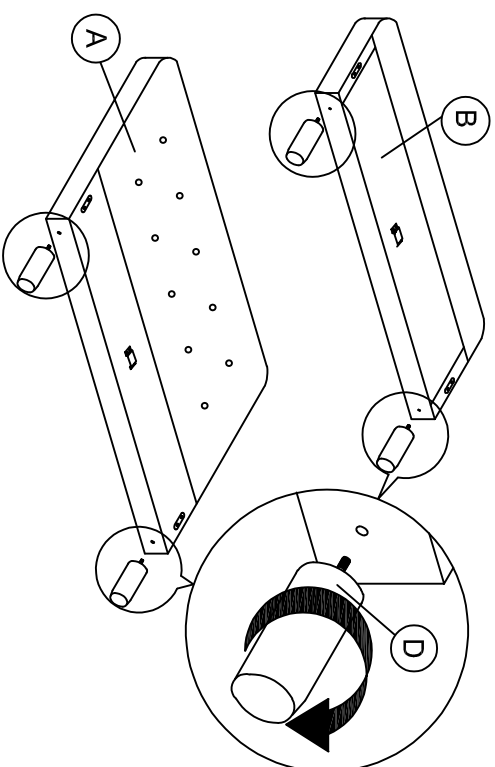

Step 2 : Attach side rail (C) to footboard (B) and headboard (A) by pushing the bracket down to fit it.

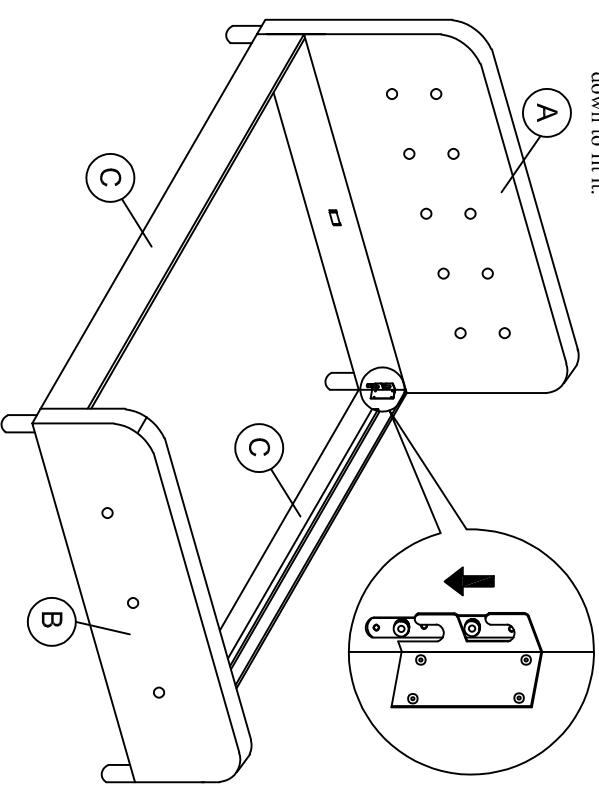

Step 3 : Attach the support legs (F) to the center rail (E) of the bed as shown.

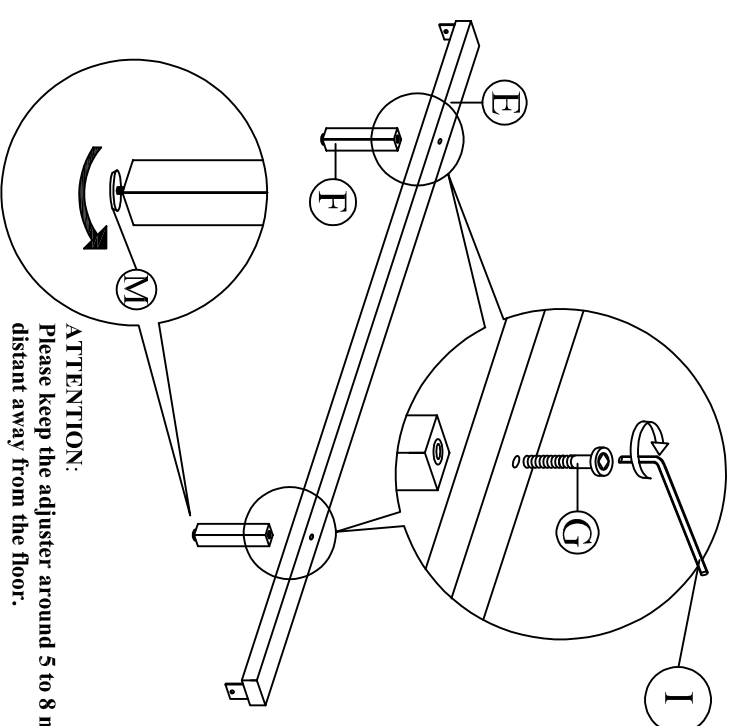

Step 4 : Slide the center rail (E) to the headboard (A) and footboard (B). Tighten screws (K) using screw driver (not included) to the headboard (A) and footboard (B).

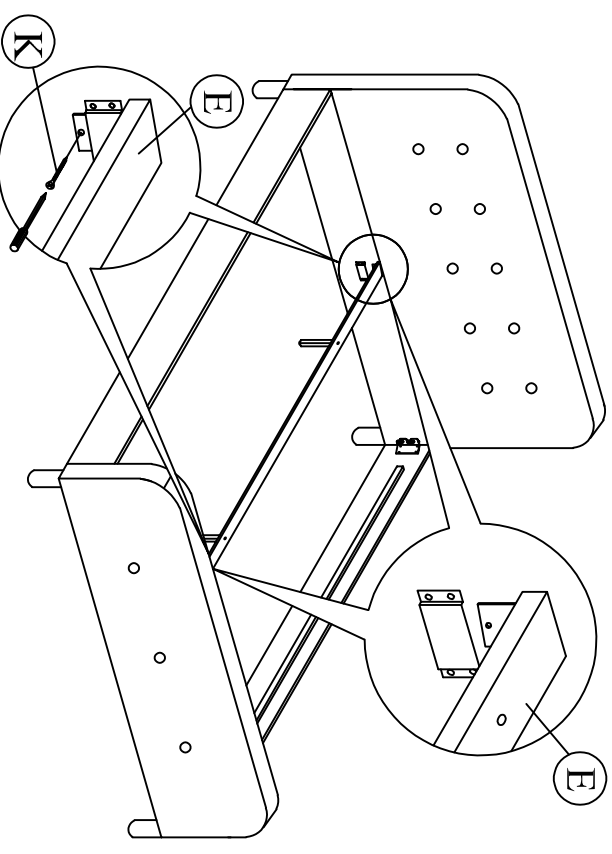

Attention : Please ensure that (K) screw is being attach as per the A.I shown to avoid base being collapse .

A	Headboard	1 pc
B	Footboard	1 pc
C	Side Rail	2 pcs
D	Legs 60 x 150(H)	4 pcs
E	Center Rail 2000mm	1 pc
F	Support Leg 215mm	2 pcs
G	JCBC M6 X 40	2 pcs
H	M5 x 70mm	1 pc
I	M4 x 65mm	1 pc
J	1597mm 14 Pcs Slat	1 pc
K	CSK M4 x 25mm	2 pcs
L	CSK M4 x 32mm	31 pcs
M	Small Adjuster	2 pcs

ATTENTION:
Please keep the adjuster around 5 to 8 mm distant away from the floor.

Step 5 : Affix the Slat (J) to the side rail support wood and the center rail (E). Tighten all the 4 corner.

